

Sustainable, energy efficient and resource saving residential buildings in consideration of unified procedures and new and adapted technologies

News 02/11

Longlife International Final Conference

This morning, on November 9th, 2011, the Longlife International Final Conference was opened by Parliamentary State Secretary, Dr. Andreas Scheuer at the Federal Ministry of Transport, Building and Urban Development.

As you can see on the pictures we have a considerable number of participants from all over the world.



Longlife results

News 02/11

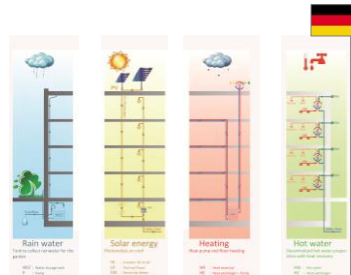

Longlife Pilot Projects

The German Pilot Project is situated in Potsdam. The building has 4 floor levels with 11 apartments and a basement. The key ideas of the project are solar orientation, modular building structure, variety of apartment typology and the use of modern technologies with renewable energies. The Longlife Pilot project meets the benchmarks with a final energy demand of 12,1 kWh/m² per year.

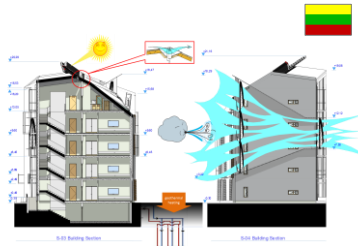

The Pilot Project of Lithuania is located in Marijampole. The buildings are 5-storey. Each building has 19 apartments. Two apartments are provided for handicapped people. The implementation of a wind powers for the energy generation is the main idea of the renewable energy concept. The energy demand of the project accounts 31,44 kWh/m² per year.

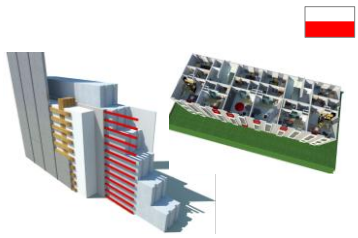

The Polish Pilot Project was designed for the City Gdynia with 24 apartments, an attic and a basement. The Pilot Project is based on the concept of an indirect heating and cooling technology driven by solar thermal radiation called Thermal Barrier (patent registration is on the way), which is composed of polypropylene U-pipes located inside of external walls. The final energy demand amounts 31,69 kWh/m² per year.

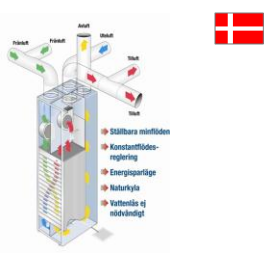

The Danish Pilot Project – Møllebænkerne - is a social housing project to be built in Borup – in the outskirts of the city Køge on Zealand. 50 apartments and a common house are designed for the project. The main goals were to find the most cost effective solution for the tenants as well as the use of renewable energy sources. The final energy demand is 15,7 kWh/m² per year.

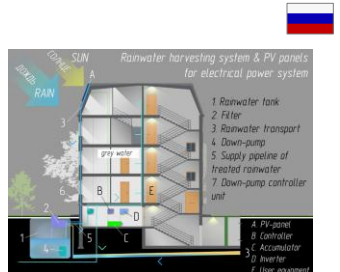

For the construction of the Russian Pilot Project the site in the village Paritsy (Gatchina district of Leningrad region) was chosen. One building with totally 21 apartments has 3 storeys and an attic.. The main challenge was to design of an energy-efficient house in the climatic conditions of North-West Russia and to prove the effectiveness of active and passive energy-saving technologies in this region.